

Smart Care[®] TRIO

Carpet Cleaner & Pile Lifter
Electric

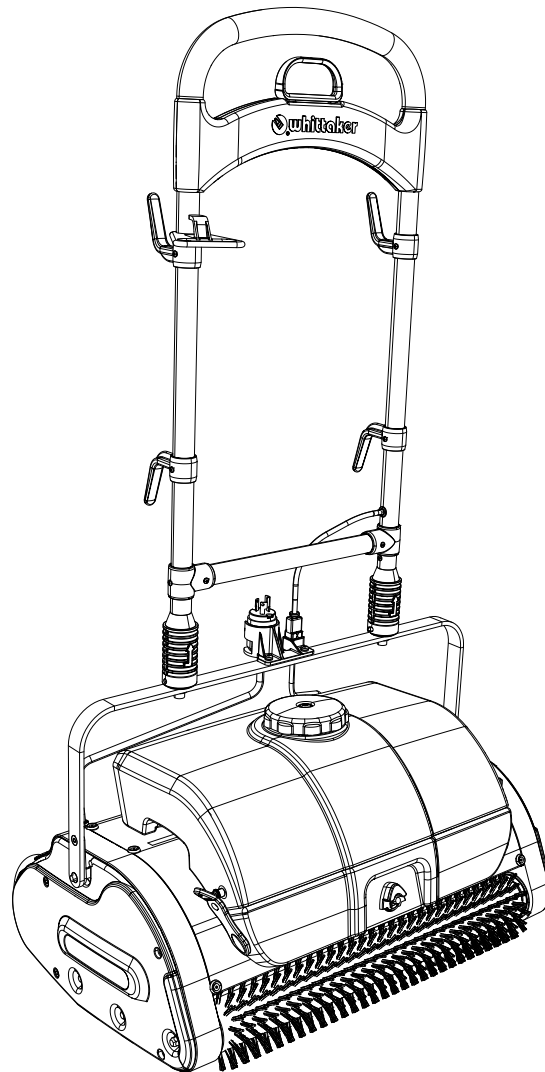

ROOTS



230V/50Hz

Operator's Manual

Read this manual completely and understand the instructions before operating the machine.
"English Version"

TABLE OF CONTENTS

<u>Description</u>	<u>Page No</u>
User information	2
Know your machine	3
Safety advice	4
General description	7
Operation	8
Cleaning instructions	10
Maintenance	11
Troubleshooting	12
Technical details	13
Limited warranty	14

USER INFORMATION

Please record identification numbers below. You should provide these numbers when ordering parts and accessories to insure accuracy.

Date of Purchase

Model No:

Serial No:

For the latest Spare Parts List, refer:

RMCL - PartsApp

KNOW YOUR MACHINE

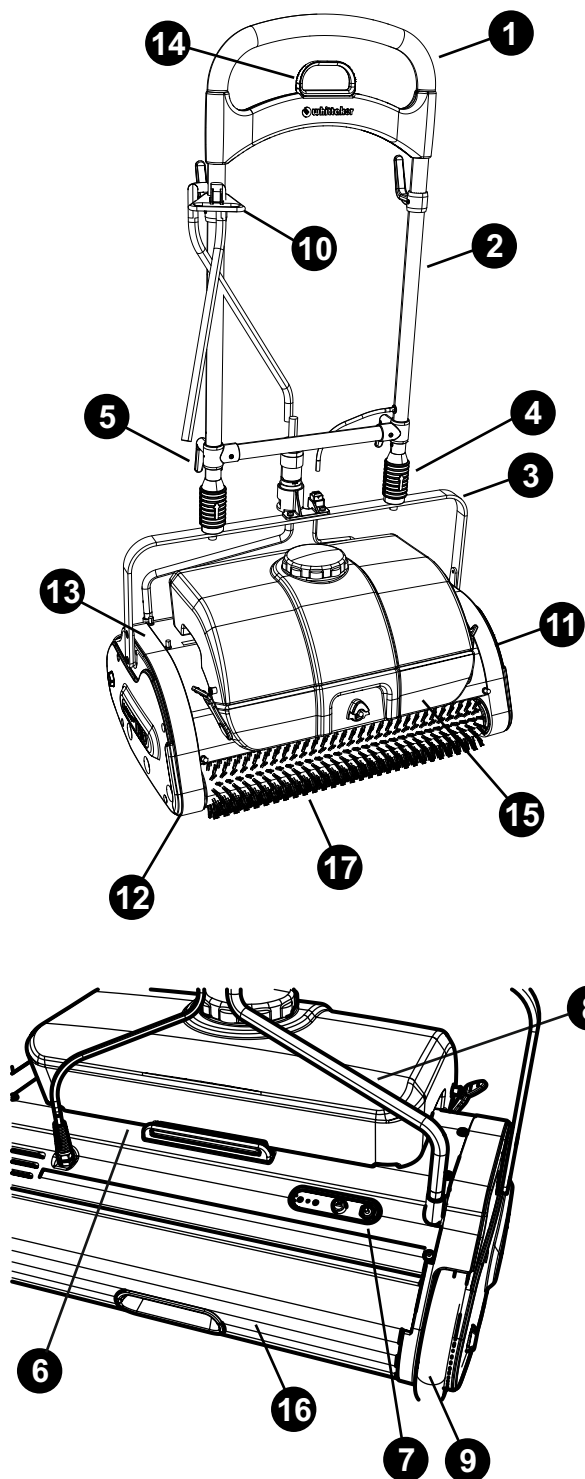

- 1 - Handle -Top Loop
- 2 - Handle Assembly
- 3 - Lower Handle
- 4 - Connector Handle Assembly
- 5 - Extension Cord Hook - Plastic (4)
- 6 - Nameplate (Under solution tank)
- 7 - Motor Protector Breaker
- 8 - Power cord-from base
- 9 - Transport wheels (2)
- 10 - Cable Retainer
- 11 - Gear Side Housing
- 12 - Idle Side Housing
- 13 - Machine Base
- 14 - Pull Handle
- 15 - Fresh Water Tank
- 16 - Collection Hopper
- 17 - Brush

All information, illustrations and specifications in this manual are based on the latest information at the time of publication. The right is reserved to make changes at any time without notice.

SAFETY ADVICE

CAUTION - Safety Advice



This machine has rotating brushes.

- Do not run over electrical, telephone or computer cables.
- Do not leave machine plugged in when unattended.
- Keep children away.
- Ensure handle is in upright position and lock is working correctly prior to connecting to power supply.
- Do not run machine over loose carpet fibers or edges of rugs or carpet matting.
- Always test clean an area when cleaning a different carpet or after changing to different brushes.

Electrical:

- Disconnect power cord at wall outlet before changing brushes, lifting machine off floor or servicing.
- Keep away from water.
- Inspect power cord prior to each use for abrasion or cuts. If cuts are found replace cord before use.
- This machine shall be grounded while in use to protect the operator from electric shock. The machine is provided with a three-conductor cord and a three-contact grounding type attachment plug as in below sketch. The green (or green and yellow) conductor in the cord is the grounding wire. Never connect this wire to other than the grounding pin of the attachment plug.



Main plug: EURO



Interconnecting receptacle



SCHUKO Plug

For service please contact our service technicians at the address or number below.

***Continuous passes over the same area with any brush may damage the carpet fibers.
Use with caution***

**IT IS THE USER'S RESPONSIBILITY TO OPERATE THIS
APPLIANCE SAFELY AND CAREFULLY.**

SAFETY ADVICE

CAUTION - Safety Advice

General Guidelines

- In addition to the information contained in this manual, generally applicable legal provisions for Safety and Prevention of accidents must be adhered to.
- Please go through the manual and the instructions contained herein carefully, even if you possess prior experience in operating similar carpet cleaning equipment.
- Schedule some time for the careful and thorough perusal of the manual contents.
- The responsibility of all persons in the working area fall upon the operator of the machine.
- No persons, children included, should be allowed within the zone of danger.
- The warning and instruction plates attached to the machine carry important advice on safe operation of the machine.
- Lost or illegible stickers must be replaced at the earliest.
- Prior to operation of the machine, the operator must ensure that the machine and its working implements are in proper and safe operating condition.
- Machines with identified and known defects must not be used.
- It is important that operators and all persons likely to use the machine familiarize themselves with all accessories and controls, as well as their functions, before commencing operation.
- Adherence to the above general instructions will help avoid the operator from having to read the manual while operating the machine.
- The machine is not intended for use by persons (including children) with reduced physical, sensory or mental capabilities, or lack of experience and knowledge.

Safety during machine operation

- The machine is applicable for carpet restoration only.
- Carpet cleaning machines may be run by qualified personnel only.
- The machine may be used for cleaning such surfaces approved by the owner or this authorized representatives.
- The machine is only suitable for use on the types of surfaces specified in the owner's manual.
- Protect the machine from frost or extremely low temperatures.
- Do not clean burning or glowing debris.
- This machine must not be operated by persons (including children) with limited physical ability, sensoric/mental capabilities or lack of experience, unless such persons are supervised by the person in charge.
- Children should be prevented from playing with the machine.
- The operator must use the machine properly. The operator must consider the local conditions and must pay attention to third parties especially children when operating the machine.
- Never leave the machine unattended when the motor is running.
- The operator must leave the machine only after the motor has come to a complete standstill.
- Prior to starting work, the operator has to check the machine's safety devices are working properly.
- The operator must wear tight fitting clothes only. The operator should wear safety shoes only when operating or while carrying out maintenance work.
- Loose fitting clothes or shoes must not be worn by the operator or any maintenance personnel who are intended to work on/with the machine.
- Check the immediate surrounding prior to starting. Ensure sufficient visibility!
- The operator must always use safety gloves, shoes while operating/maintaining the machine.

SAFETY ADVICE

Safety during machine operation

- On inclined/tilted surfaces, the tilt angle and the driving direction should not exceed the values given in this manual.
- Smoking or naked flames are strictly prohibited.
- Always allow the machine sufficient time to cool before carrying out any repair or maintenance work.
- Do not place hand or any object while the brushes are running.
- Suitable tools must be used for cleaning and maintenance work.
- Do not carry out any welding, drilling, sawing or grinding work on the frame sections. Damaged parts may only be changed at an authorized service center.
- It is not permitted to use aggressive and corrosive cleaning agents.
- Maintenance work may be carried out by authorised dealer only.
- Always use appropriate tool and equipments while working on the machine.
- The cable must not chafe against anything. In the case of defective insulation, do not use the on-board charger.
- Do not use harsh chemicals to clean the machine.



This machine is not suitable for evacuation of dusts, which are explosive or dangerous to health.

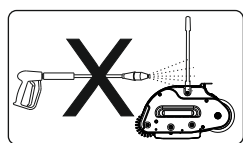

Do not clean the machine by means of vapour jet or high pressure cleaning equipment.

GENERAL DESCRIPTION

Your Smart Care[®] TRIO machine is designed to give you excellent performance and long life.

This machine is ideal to clean carpeted floors in facilities like offices, schools, hospitals, airports, hotels, casinos, and similar commercial applications.

Reading this manual will help you get the most from its many features.

CAUTION: This machine is for indoor use only.

CAUTION: This machine shall be stored indoors only.

NOTE: This machine has been designed exclusively for carpet restoration and not for hard surfaces.

ASSEMBLY:

In the box you will find: machine base (shipped with brushes installed), and the handle assembly.

A. Remove the machine base from the packing and place it squarely on the floor. To do this, raise the bottom handle upright until it locks.

B. Remove the handle assembly from the packing and place it on a scratch-free surface.

C. Insert the top handle assembly into the bottom handle assembly and affix the four screws through the washers.

D. Place assembled handle on handle cone assembly indicated by the arrow in fig. Plastic cord holders should face towards rear of machine, the same as large cord hook.

Be sure the connector assembly is locked in completely or the connectors may break and possibly cause damage to the locking mechanism.

To attach the handle, grasp the ribbed plastic connector (1) at the base of the handle, align with the two cones on the lower handle bar, press down and turn clockwise until it clicks into place. To remove handle, turn counter-clockwise and lift up.

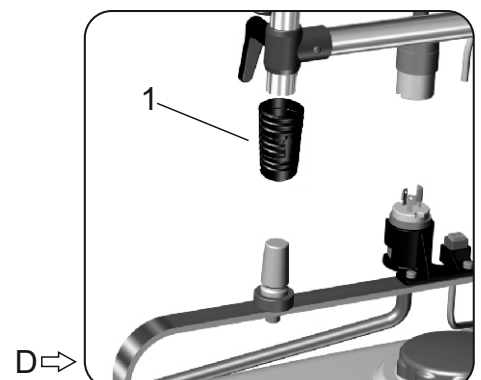
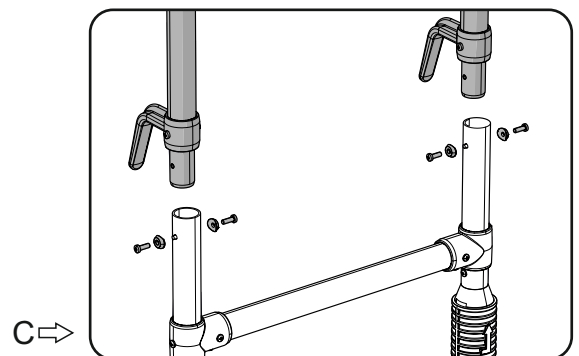
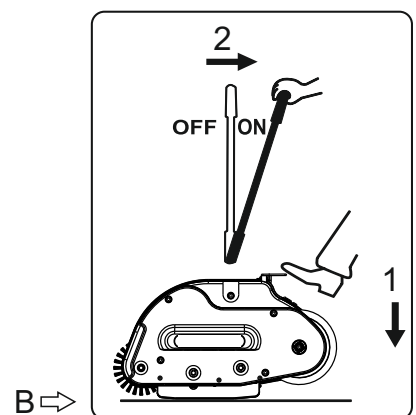
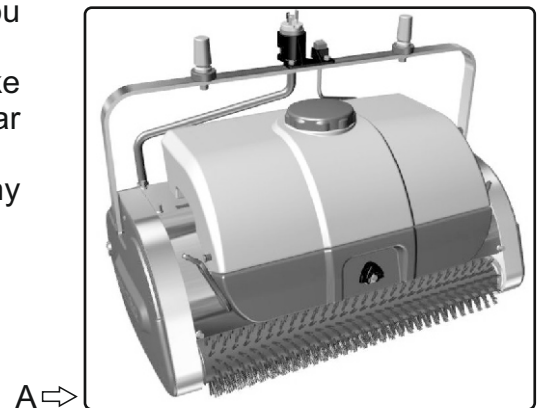

OPERATION

- A. Move the assembled machine to the work location.
- B. Fill solution tank with desired CRYSTAL[®] cleaning solution.
- C. Connect power cord to grounded outlet.
- D. Press the pedal while lowering the handle backwards.
- E. Slowly lower handle. This reduces the initial startup friction.
- F. To turn off the machine, return the handle to its upright and locked position.

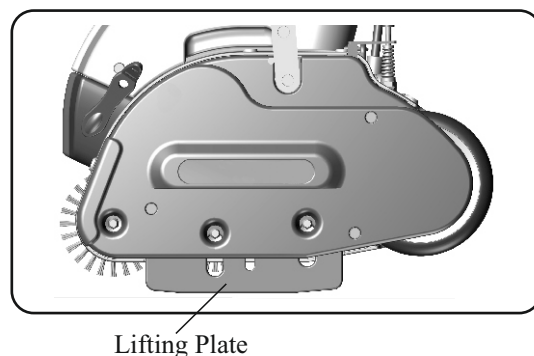

BRUSH REMOVAL:

- A. **Unplug power cord.**
- B. Tilt machine back on its wheels until handle rests on the floor.
- C. With a finger, push axles outwards and pull out. No tools are required if machine is kept clean.

Note: Brushes should be removed and rotated end-to-end regularly (every 2-3 hours).

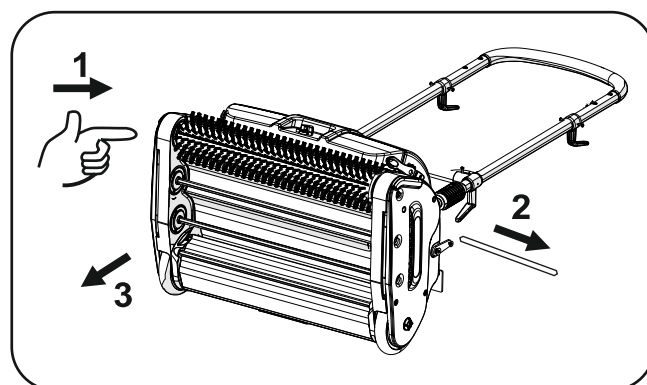

BRUSH SELECTION:

Caution:

After a pass or two, the carpet fibers have been fully agitated and the pile lifted. If additional cleaning of an area is required, allow fibers to dry, vacuum then repeat process.

Continuous passes over the same area with any brush may damage the carpet fibers. Use with caution.

Even the softest brush can cause damage if operated repeatedly in one area. The best advice is to be safe. In heavily matted/soiled areas, operate machine with overlapping passes, then operate at right-angle if possible. Do not use any more than two passes in each direction in a single cleaning operation. Repeated operations over a few days or weeks are sometimes necessary in situations where abuse and neglect (under cleaning or improper chemistry) have occurred. It is not acceptable in any situation to expect more of the machine and process than is seen in two passes in each direction.

COLOR	DESIGNATION	GENERALLY RECOMMENDED FOR	CAN BE USED FOR	CAUTIONARY STATEMENT
WHITE	SOFT	RESIDENTIAL, SOFT CUT PILE, BERBERS, WOOL, ORIENTAL, PERSIAN CARPETS	LIGHT TO MODERATE SOIL	USE WITH CAUTION
GRAY	MEDIUM	COMMERCIAL-LEVEL LOOP, OR LOW CUT PILE	LIGHT TO MODERATE SOIL	USE WITH CAUTION
BLACK	FIRM	COMMERCIAL LOOP	MODERATE TO HEAVY SOIL MATTED/CRUSHED	USE WITH CAUTION

OPERATION

LABELS ON THE MACHINE:

Operation Decal

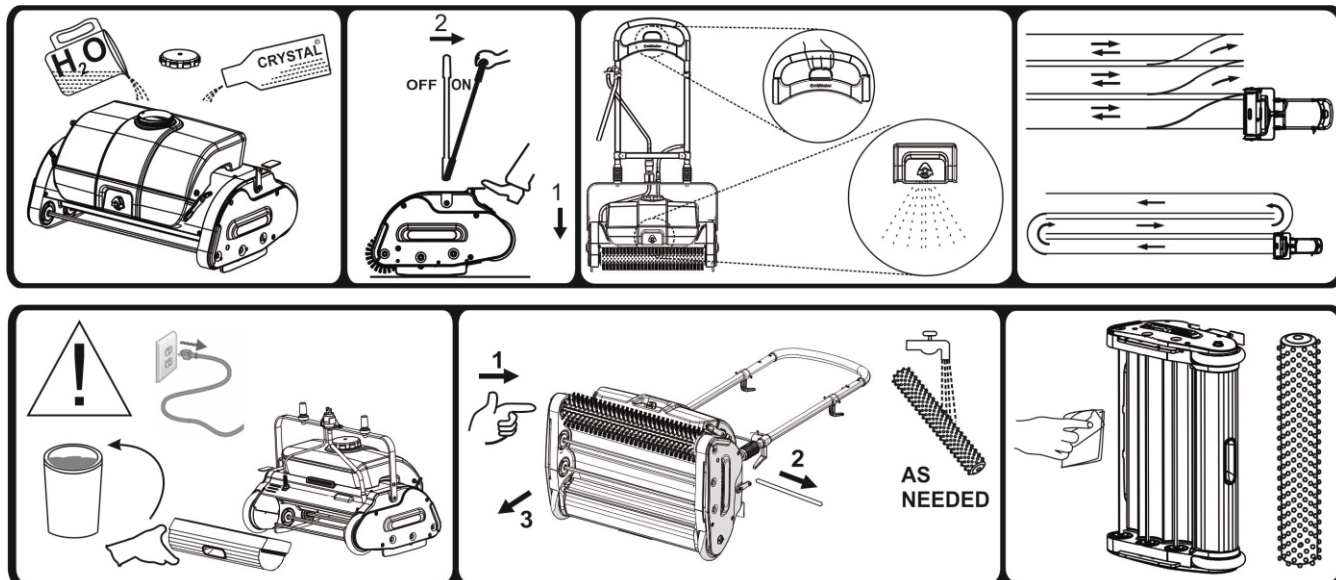

CLEANING INSTRUCTIONS

Cleaning Instructions:

WARNING: This machine is not intended for use by persons (including children) with reduced physical, sensory or mental capabilities, or lack of experience and knowledge.

CAUTION: Children should not play with the machine.

WARNING: Operators should be adequately instructed/trained on the use of these machines.

-Mix Crystal[®] Dry Extra solution according to instructions on the bottle.

-Run Smart Care[®] TRIO machine back and forth as you would a vacuum, or in straight rows as you would a lawn mover. For heavily soiled areas, run machine in 2 different directions (North/South then East/West).

Continuous passes over the same area with any brush may damage the carpet fibers. Use with caution.

- A small amount of foam appears on most fiber types for 3-5 seconds before disappearing.

- For a uniform groomed look slightly overlap each backward pass.

Light Soiling:
One Pass
Like Lawnmower

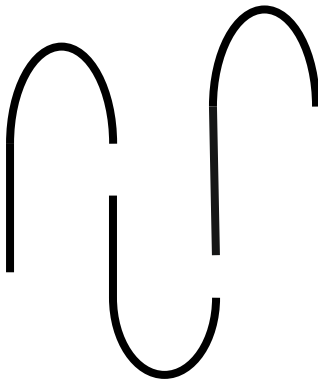

Moderate Soiling:
Two Passes
Like Vacuum



Heavy Soiling:
Multiple Passes
Like Vacuum in 2 Directions

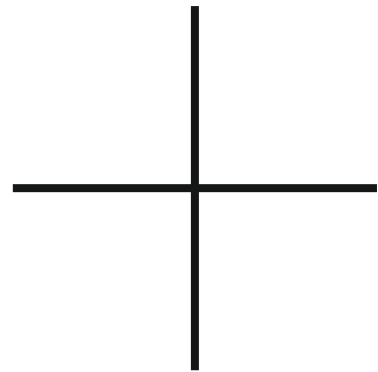

WARNING: Do not use for cleaning purposes on surfaces having a gradient exceeding 4%.

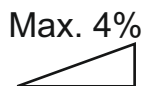

Note: After carpet is dry, in as little as 30 minutes, it may be vacuumed. However there is no need to vacuum immediately. The carpet is left bright and clean looking, with no visible “crystals”. Dirt becomes encapsulated in the dry crystals and is ready to be vacuumed at the next scheduled vacuuming. No residue is left to build up and clog carpets as with most dry compounds.

Please remember all cleaning systems will be maximized with pre-vacuuming to remove larger dry particles of soil. For optimum results we suggest vacuuming thoroughly prior to cleaning.

MAINTENANCE

WARNING: Ensure that before performing any maintenance work the mains are switched off and the power cord is unplugged from the wall socket.

During Operation:

- Rotate brushes every 2-3 hours of operation. This prolongs brush life and protects against gear damage.
- Do not lubricate axles. Keep clean and dry.
- Never rest machine with brushes directly on the floor.

CAUTION: Care should be taken while changing the brushes, fingers might get caught between the shaft and the housing.

After Each Use:

- Unplug power cord at wall outlet.
- Remove, empty and rinse solution tank.
- Remove, empty and rinse collection hopper.
- Tilt machine backwards resting on its handle.
- Reach under with a finger and push axles sideways and out. No tools are required if machine is kept clean and brushes are rotated regularly.
- Remove brushes. Inspect for wear. Use the Brush Wear Indicator hole in one end of each axle to measure bristle length.
- Wipe underside of machine with damp cloth.
- Rotate the front brush end-to-end before replacing and do the same with the other 2 brushes.

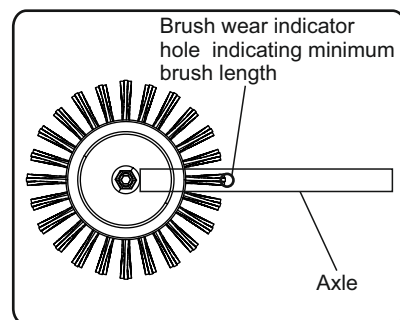
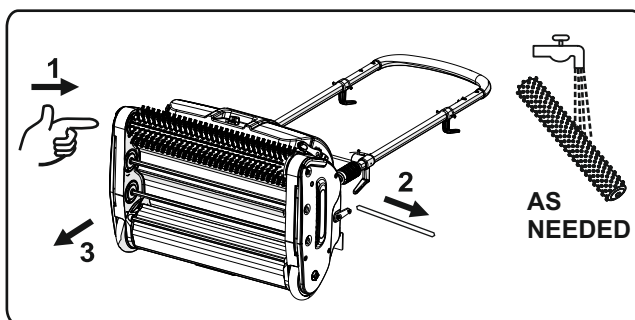
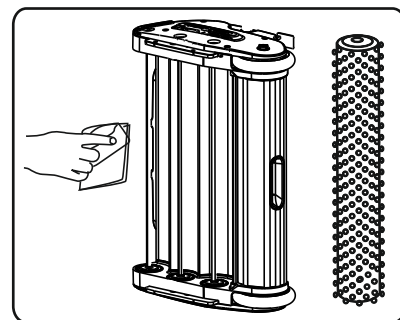
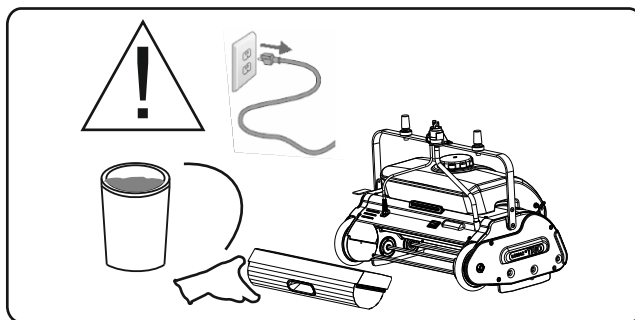

TROUBLESHOOTING

Problem

Solution

Machine does not start and makes no noise.

- Wait 30 seconds if machine is warm. Push motor protector reset button. Use a small object to be sure to press it in far enough.
- Check electrical cords and connections for breaks.

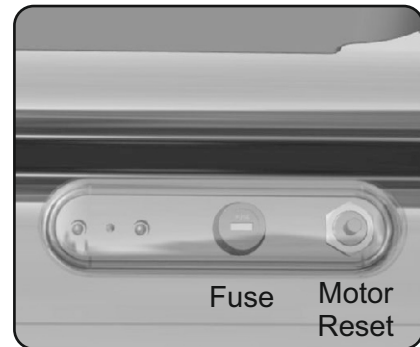

Machine does not start and makes grunting noise.

- Tilt machine toward the foot pedal side and allow brushes to rotate at full speed before lowering slowly onto the carpet.

Only one brush turns.

- One or more gears have stripped and need to be replaced before use.

Machine bounces roughly when in use.

- Inspect brushes for directional set from scrubbing in one direction too long.
- Inspect axles and brush end caps for wear which will cause a vibration.

HINT: To prevent directional set, rotate the front brush end to end, and do the same with the other two brushes. Do this at day's end or after 2-4 hours of continuous use.

Pump does not work.

- Blown fuse or loose contact.

To change fuse:

- Unplug power cord from wall outlet.
- Remove the transparent protection cover.
- Remove the fuse holder cover with a screw driver.
- Remove the blown fuse.
- Insert a new fuse of the same rating.
- Put the cover back and check for function.

TECHNICAL DETAILS

DESCRIPTION	UNIT	20 inch	15 inch
CLEANING CAPACITY(THEORETICAL) MIN	sqft/hr (m ² /hr)	(5600) 520	(4300) 400
CLEANING WIDTH	in (mm)	(20.3) 517	15.5 (390)
VOLTAGE (SINGLE PHASE)	V	230 ± 6%	230 ± 6%
FREQUENCY	Hz	50	50
POWER CONSUMPTION (MAX)	watts	1400	1100
CURRENT IN AMPS (MAX) WITH BRUSHES	A	7	6
CIRCUIT BREAKER RATING (MOTOR)	A	9	7
FUSE RATING (PUMP)	A	0.5	0.5
POWER CORD		3G x 2.5 sq.mm - H05 VVF	
NOISE LEVEL (MAX)	dB (A)	69	69
VIBRATION (MAX)	m/s ²	<2.5	<2.5
BRUSH SPEED - OUTER/CENTER	rpm	465/640	465/640
FRESH WATER TANK CAPACITY	gal (liters)	2.5 (9.5)	2.5 (9.5)
OVER ALL DIMENSIONS:			
HEIGHT WITH HANDLE	in (mm)	47.25 (1200)	47.25 (1200)
HEIGHT WITHOUT HANDLE	in (mm)	13.78 (480)	13.78 (480)
WIDTH	in (mm)	25.59 (650)	20.67 (525)
LENGTH	in (mm)	17.72 (450)	17.72 (450)
DRY WEIGHT	lbs (kg)	61.72 (28)	55.11 (25)

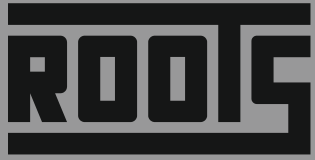

Roots Multiclean Ltd.

R.K.G. Industrial Estate, Ganapathy,
Coimbatore - 641 006, India.



+91 (422) 4330 330



rmclsales@rootsemail.com



rootsmulticlean.com



+91 95978 12345

